

Q409.001

1999-2004 Yamaha

230 Bear Tracker

Stage 1

For mildly tuned machines using the stock airbox with stock or aftermarket filter. May also be used with a good aftermarket exhaust system.

<i>Parts List</i>		
1	Main Jet	DJ090
1	Main Jet	DJ092
1	Main Jet	DJ094
1	Main Jet	DJ096
1	Main Jet	DJ098
1	Main Jet	DJ100
1	Fuel Needle	DNO360S
1	Adjusting Washer	DW0001
1	E-Clip	DE0001

STAGE ONE INSTRUCTIONS

1. Remove vacuum slide from the carb. Remove stock needle & spacers, noting order of assembly (Fig. A).
2. Install the Dynojet needle on groove #4 for applications below 5000 feet, groove #3 for above 5000 feet, using all stock spacers. Install the Dynojet washer above the E-clip.
3. Remove the stock main jet. If you are running the stock exhaust, use the DJ096 below 3000 feet, DJ094 from 3000 to 6000 feet and DJ092 above 6000 feet. If you are running an aftermarket exhaust, use the DJ098 below 3000 feet, DJ096 from 3000 to 6000 feet and DJ094 above 6000 feet. Be sure that the jet you are changing is the main jet (Fig. B).
4. Locate the Fuel Mixture Screw (Fig. B). Using a flat blade screwdriver, turn the mixture screw clockwise until it seats, then turn out 2 turns below 5000 feet or 1 1/2 turns above 5000 feet.

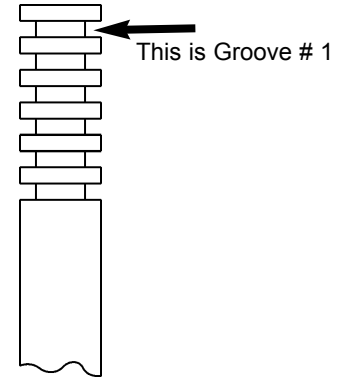

Fig.A

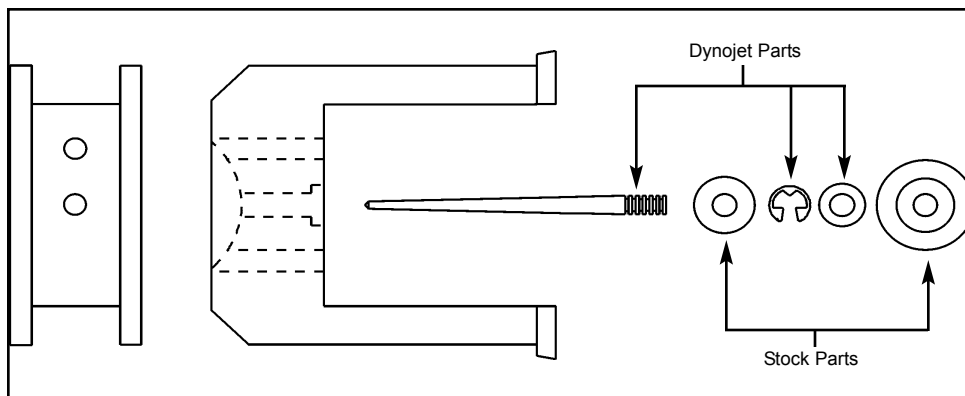

Fig.B

